

PARTS LIST				
ITEM	QTY	ISSUE	PART NUMBER	DESCRIPTION
1	1	k	152-03-1025	Body Sub Assembly
2	1	b	152-02-1016	base
3	1	a	152-02-1029	sill
4	1	i	152-03-1026	door sub assy.
5	16		M8SLFHRN	M8 S/S Large Flange Hexsert
6	4		412SCPHM	M4 x 12 S/S CSK Pozi Machine Screw
7	4		M4SN	M4 S/S Nut

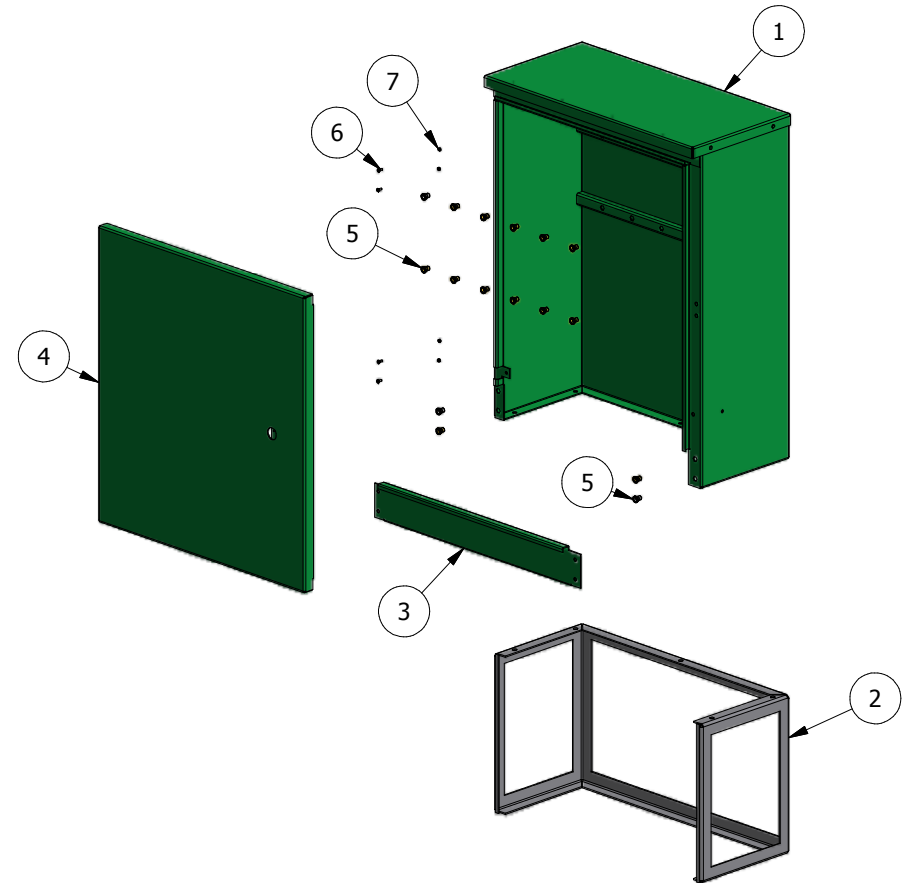

REVISION HISTORY

REV	DESCRIPTION	DATE	APPROVED	ECN #
M	lintel rivets updated	15/03/2013	ND	1240
N	door updated to close up gap	6/11/2013	ND	1351

	TOLERANCES: LINEAR: ±0.5 ANGULAR: ±0.5°	DRAWN: Chris Woods CHECKED:	DATE: 16/06/2011	CUSTOMER: RDL Limited	TITLE: AL700x900x340 ~ Final Assembly	DRAWING NO. - REV. 152-04-1024 (n)
		UNLESS OTHERWISE SPECIFIED: DIMENSIONS ARE IN MILLIMETERS	CAD GENERATED DRAWING DO NOT MANUALLY UPDATE DO NOT SCALE DRAWING	WEIGHT: 23.06 kg	MATERIAL: as parts	Customer reference ~ FINISH: natural SHEET OF SHEET: 1 / 1