

PARTS LIST				
ITEM	QTY	ISSUE	PART NUMBER	DESCRIPTION
1	1	a	152-02-1103	Base
2	1	e	152-03-1106	Body Sub Assembly
3	1	b	152-02-1102	Sill
4	1	c	152-03-1104	Door Sub Assembly
5	14		M8SLFHRN	M8 S/S Large Flange Hexsert
6	4		412SCPHM	M4 x 12 S/S CSK Pozi Machine Screw
7	4		M4SN	M4 S/S Nut

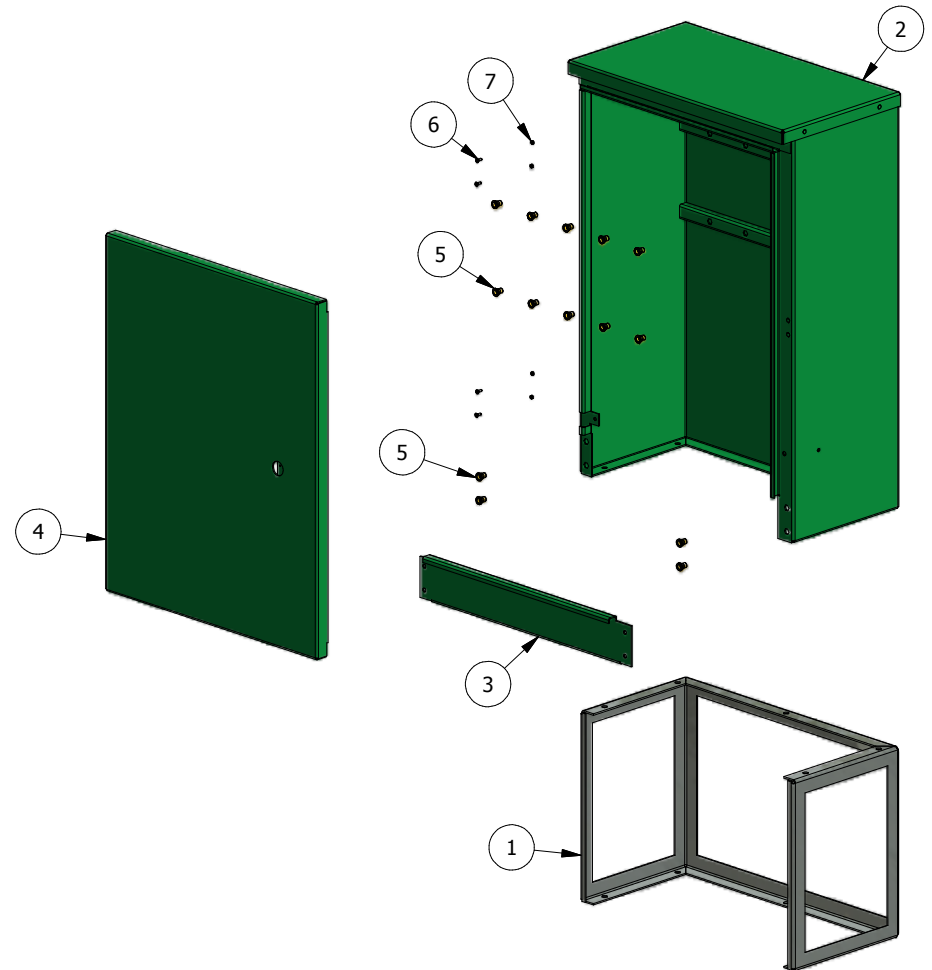

REVISION HISTORY

REV	DESCRIPTION	DATE	APPROVED	ECN #
E	intel rivets updated	15/03/2013	ND	1240
F	door updated to close up gap	6/11/2013	JW	1351

	TOLERANCES: LINEAR: ±0.5 ANGULAR: ±0.5°	DRAWN: Chris Woods CHECKED:	DATE: 8/06/2011	CUSTOMER: RDL Limited	TITLE: AL600x900x340 ~ Final Assembly	DRAWING NO. - REV. 152-04-1107 (f)
		UNLESS OTHERWISE SPECIFIED: DIMENSIONS ARE IN MILLIMETERS	CAD GENERATED DRAWING DO NOT MANUALLY UPDATE DO NOT SCALE DRAWING	WEIGHT: 19.75 kg	MATERIAL: as parts	CUSTOMER reference ~